

# E99-24

IBC: 1024.3; IFC: [BE] 1024.3

**Proponents:** Jeffrey Grove, Coffman Engineers, Coffman Engineers (jeff.grove@coffman.com)

## 2024 International Building Code

**Revise as follows:**

### 1024.3 Construction.

*Exit passageway* enclosures shall have walls, floors and ceilings of not less than a 1-hour *fire-resistance rating*. The fire-resistance rating of an exit passageway, where extending from an interior exit stairway or ramp, shall not be less than that required for the , and not less than that required for any connecting interior exit stairway or ramp. Exit passageways shall be constructed as *fire barriers* in accordance with Section 707 or *horizontal assemblies* constructed in accordance with Section 711, or both.

## 2024 International Fire Code

**Revise as follows:**

### [BE] 1024.3 Construction.

*Exit passageway* enclosures shall have walls, floors and ceilings of not less than a 1-hour *fire-resistance rating*. The fire-resistance rating of an exit passageway, where extending from an interior exit stairway or ramp, shall not be less than that required for the , and not less than that required for any connecting interior exit stairway or ramp. Exit passageways shall be constructed as *fire barriers* in accordance with Section 707 or *horizontal assemblies* constructed in accordance with Section 711, or both.

**Reason:** It is clearly the intent of the Code that an exit passageway, whether required for travel distance or some other reason, may be of minimum one-hour fire-resistance rating, regardless of the type of construction or number of stories in a building. There are many times that this is misinterpreted that if you are located in a Type I building, or several stories up in a structure, that the exit passageway must be two-hour rated.

The Code Commentary already states that “Where extending an enclosure for an exit stairway, the rating must not be less than the enclosure for the exit stairway so that the degree of protection is kept at the same level.” This proposal is intended to clarify these code provisions.

This is a similar proposal as E98-21 which was Approved as Submitted during the Public Comment Hearings, but was ultimately disapproved during the OGCV. To further clarify the intention of this proposal, exhibit schematics have been included with this submission. These examples illustrate this language as follows:

- One-story Type IA building - an exit passageway is required to be a minimum of 1-hour fire-resistance construction, regardless that the building has a required structural fire-resistance greater than 1-hour.
- Three-story Type IIB building - the exit passageway on Level 3 is required to be a minimum of 1-hour fire-resistance construction. The interior exit stairway is required to be of minimum 1-hour fire-resistance construction, and any exit passageways that extend from the stairway are to be of minimum 1-hour fire-resistance construction.
- Three-story Type IA building - the exit passageway on Level 3 is required to be a minimum of 1-hour fire-resistance construction. The interior exit stairway is required to be of minimum 2-hour fire-resistance construction (due to the penetrated 2-hour floor assemblies), and any exit passageways that extend from the stairway are to be of minimum 2-hour fire-resistance construction.
- Five-story building of any construction type - the exit passageway on Level 5 is required to be a minimum of 1-hour fire-resistance construction. The interior exit stairway is required to be of minimum 2-hour fire-resistance construction, and any exit passageways that extend from the stairway are to be of minimum 2-hour fire-resistance construction.

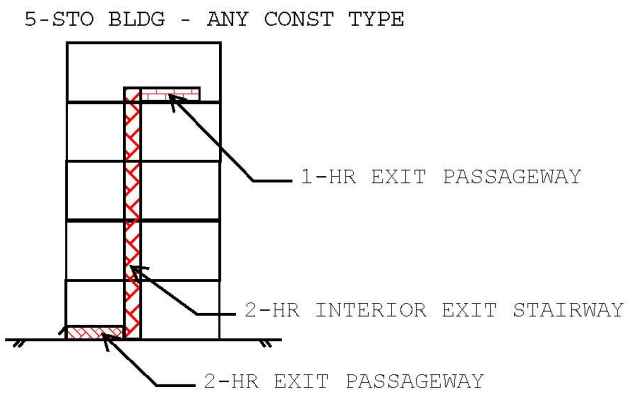
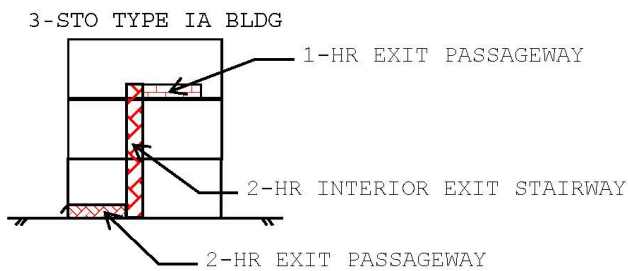
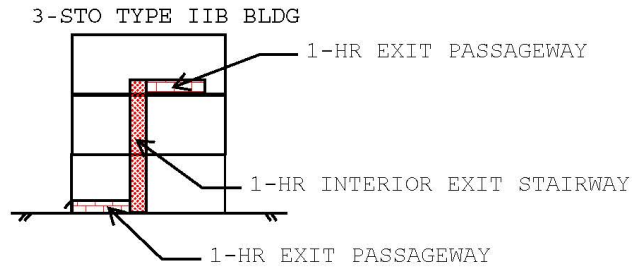
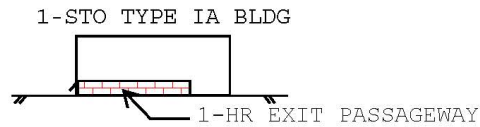

**Cost Impact:** The change proposal is editorial in nature or a clarification and has no cost impact on the cost of construction

**Justification for no cost impact:**

The proposed text clarifies the existing intent for the rating of exit passageway.